

# CBD

## THREAD MOUNTING

### SERIES CBD - REPLACEABLE ELEMENT

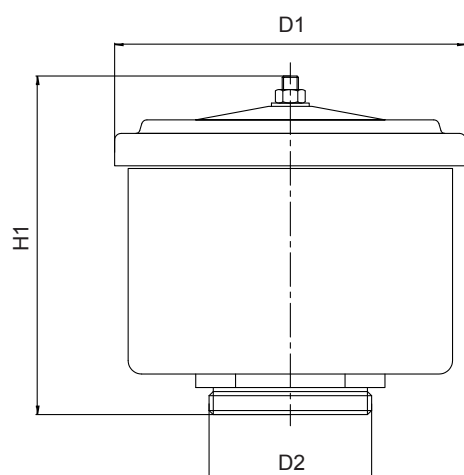

### DIMENSIONS

	Flow rate (l/min)	D1	D2	H1	kg
CBD11	500	130	2" BSP	100	0,50
CBD12	1.000	130	2" BSP	130	0,60
CBD13	1.500	130	2" BSP	175	0,80

### ORDERING AND OPTION CHART

C TYPE				ELEMENT		E
C = ACCESSORY PRODUCT				C	C	C
B D FAMILY, SIZE & LENGTH				FAMILY, SIZE & LENGTH		B D
				11	12	13
B CONNECTION TYPE						
B = BSP thread				B	B	B
1 6 CONNECTION SIZE						
16 = 2"				16	16	16
FILTER MEDIA				FILTER MEDIA		
VD = velvet mesh				VD	VD	VD
FD = glassfiber				FD	FD	FD
CD = cellulose				CD	CD	CD
				VD = velvet mesh		
				FD = glassfiber		
				CD = cellulose		

### MATERIALS

Housing:  
Painted steel (black)

### SPARE FILTER ELEMENT

VD - Velvet mesh  
Filtration degree (in air) 10µm.

FD - Glass fiber (on request only)  
Filtration degree (in air) 2,5µm.

CD - Cellulose (on request only)  
Filtration degree (in air) 10µm.

### COMPATIBILITY

Full with fluids HH-HL-HM-HV-HTG  
(according to ISO 6743/4). For fluids  
different than the above mentioned, please  
contact our Sales Department.

### WORKING TEMPERATURE

From -25°C to 110°C



Is this datasheet  
the latest release?  
Please check  
on our website.



Technical data subject to variations without prior notice. CBD - EN - 03/2011